

# JUMPED CHOCK SERIES CODES

REV 18MAY21

## Severity/Condition Codes (0 thru 7)

- 0 - No Damage
- 1 - Broken
- 2 - Cracked
- 3 - Strap loose, fallen or twisted
- 4 - Chock Spacing
- 5 - Not locked in track or disengaged
- 6 - Missing
- 7 - Mixed chock types on vehicle

## Adjacent Damaged Vehicle Codes (8 and 9)

- 8 - Forward vehicle damaged by jumped unit
- 9 - Rearward vehicle damaged by jumped unit



## 40 Series

*Holden*



**60 - 40:**  
Holden Grate - Lock Chock  
Maximum Spacing: ¾"



**60 - 42:**  
Holden Grip - Lock Chock  
8 Chock Configuration  
Maximum Wedge Spacing: 5/8"  
Chock Face to Tire Spacing: 0"



**60 - 43:**  
Holden Grate - Lock Chock  
With Holden Block Chock



**60 - 44:**  
Holden Grate - Lock Chock  
with AVR supplemental



**60 - 45:**  
Holden Grip - Lock Chock with  
4 Chock Configuration  
Maximum Wedge Spacing: 5/8"  
Chock Face to Tire Spacing: 0"

## 50 Series

*Holland*



**60 - 50:**  
Vehicle Restraint System (VRS)  
Maximum Spacing: ¾"



**60 - 51:**  
Tri Lo Chock  
Maximum Spacing: 1 ¼"



**60 - 52:**  
Lock & Load Chock  
Maximum Spacing: ¾"

## 60 Series

*Trinity*



**60 - 60:**  
Thrall Wedge Polymer  
Chock & Strap with Low  
Profile Winch  
Maximum Spacing: 1 1/4"



**60 - 61:**  
Thrall Wedge Steel Chock &  
Strap with Low Profile Winch  
Maximum Spacing: 1 1/4"



**60 - 63:**  
Thrall Wedge Steel Chock &  
Strap with High Profile Winch  
Maximum Spacing: 1 1/4"

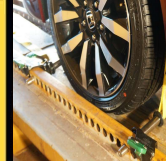

**60 - 64:**  
Trinity Through Track Mandrel  
(TTM)  
Maximum Spacing: 1 1/4"

## 70 Series

*Wabtec*

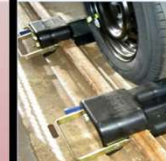

**60 - 70:**  
Wabtec Non-metallic  
LoPro Chock  
Maximum Spacing: 1 ¼"



**60 - 71:**  
Wabtec Steel LoPro Chock  
Maximum Spacing: 1 ¼"



**60 - 72:**  
Wabtec Sta-Put Chock (with  
and without optional strap)  
Maximum Spacing: ¾"



**60 - 73:**  
Wabtec CoPoly Chock  
Maximum Spacing: 1 ¼"



**60 - 75:**  
Wabtec Hybrid LoPro Chock  
Maximum Spacing: 1 ¼"

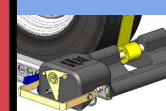

**60 - 76:**  
Wabtec Non-metallic LoPro  
(Model II) Chock  
Maximum Spacing: 1 ¼"